

FLAT RECTANGULAR CUPS WITH NON-SLIP SUPPORT

These cups share the same technical and mechanical features with the ones described above, but their support has a special non-slip plastic coating that make them particularly suited for clamping glass and smooth marble.

A built-in stainless steel mesh filter in the suction hole and an O-ring seal at the base of their support are the other main features of these cups.

They are also provided with two or for housings for TCCE screws, according to their size, for fixing them to the workstation.

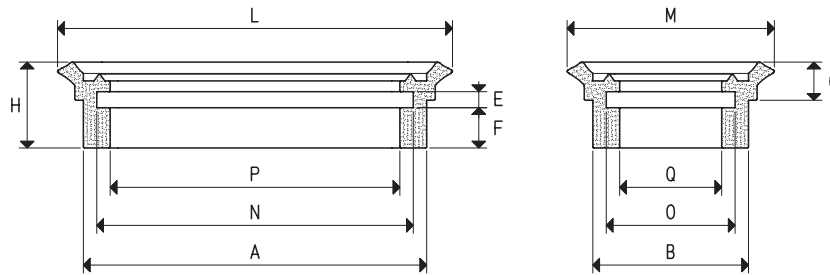

CUPS

Art.	Force Kg	A	B	E	F	G	H	L	M	N	O	P	Q
01 40 75 *	6.7	64	29	3	7.5	6.5	16.0	75	40	59	24	54	19

* Complete the code indicating the compound: A= oil-resistant rubber; N= natural para rubber; S= silicon

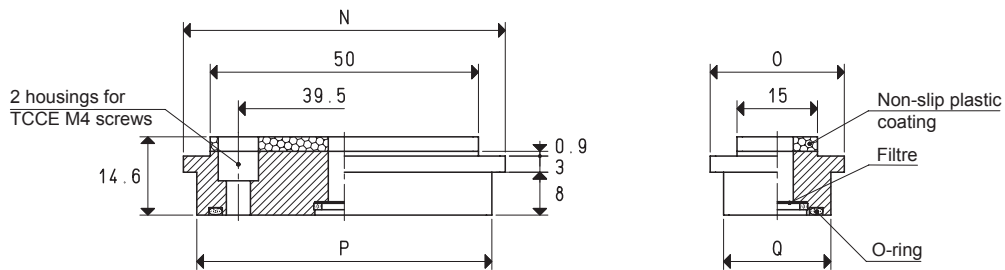

SUPPORT

Art.	N	O	P	Q	Support material	Cup art.	Weight g
00 08 184	60	25	55	20	aluminium	01 40 75	38.7

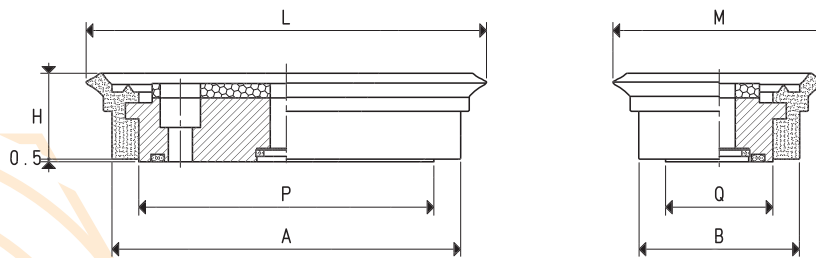

CUP WITH SUPPORT

Art.	Force Kg	A	B	H	L	M	P	Q	Cup Art.	Support Art.	Weight g
08 40 75 M1 *	6.7	66	31	16.0	76	41	55	20	01 40 75	00 08 184	53.5

* Complete the code indicating the compound: A= oil-resistant rubber; N= natural para rubber; S= silicon

FLAT RECTANGULAR CUPS WITH NON-SLIP SUPPORTS

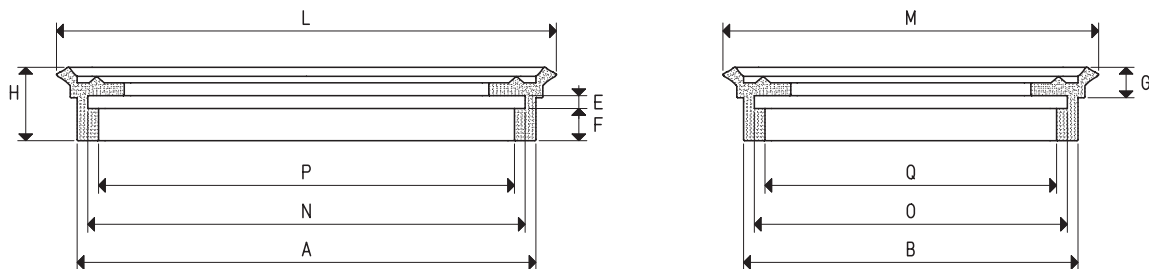

CUPS

Art.	Force Kg	A	B	E	F	G	H	L	M	N	O	P	Q
01 120 90 *	24.0	107	78	3	7.5	7.5	17.5	117	87	102	73	97	68
01 150 75 *	25.0	137	62	3	7.5	7.5	16.5	147	72	132	57	127	52

* Complete the code indicating the compound: A= oil-resistant rubber; N= natural para rubber; S= silicon

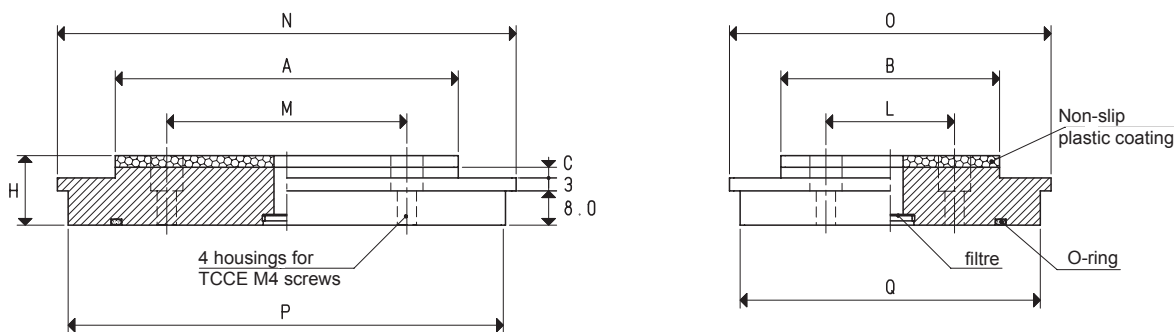

SUPPORTS

Art.	A	B	C	H	L	M	N	O	P	Q	Support material	Cup art.	Weight g
00 08 256	82	50	2.5	16.2	30	56	107	75	102	70	aluminium	01 120 90	244.5
00 08 257	110	35	2.3	16.4	20	92	135	60	130	55	aluminium	01 150 75	247.9

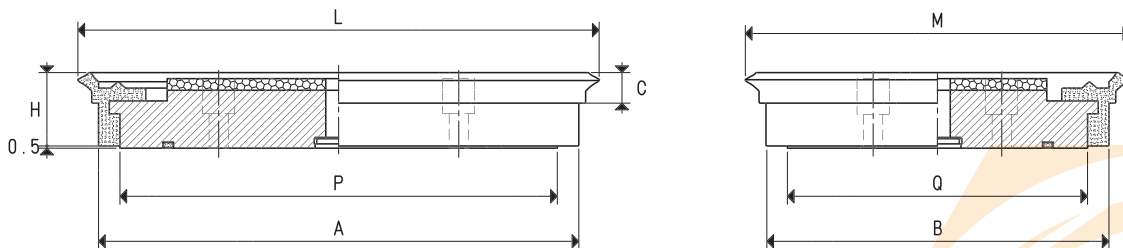

CUPS WITH SUPPORT

Art.	Force Kg	A	B	C	H	L	M	P	Q	Cup Art.	Support Art.	Weight g
08 120 90 M1 *	24.0	112	80	7.5	17.5	120	90	102	70	01 120 90	00 08 256	283.3
08 150 75 M1 *	25.0	140	65	7.5	16.5	150	75	130	55	01 150 75	00 08 257	289.1

* Complete the code indicating the compound: A= oil-resistant rubber; N= natural para rubber; S= silicon

Conversion ratio: inch = $\frac{mm}{25.4}$; pounds = $\frac{g}{453.6}$ = $\frac{Kg}{0.4536}$